



# Power Brick Solid State

Lithium-Ion battery

Smart



## 12V Solid-State battery pack - LiFePO<sub>4</sub> - 212Ah - 2.71kWh

- **High lifespan: 4500 cycles** and more (see chart)
- **New Solid-State cell technology** for better performance and safety
- **Active Balancing** for fast, efficient cell voltage equalization
- **Remote monitoring by Bluetooth** (SOC, cell voltage, SOH, etc.)
- **Fast recharge** in less than one hour
- **Ultra safe Solid-State Lithium Iron Phosphate** chemistry (no thermal run-away, no fire or explosion risks)
- **Embedded BMS** (Battery Management System) : **improve lifespan and safety of the battery**
- **Strict cell matching** for pack consistency. Laser cell welding
- **Precharge system** for high capacitance loads
- No **Cobalt**, no **Manganèse**, no **Nickel**, no **rare earth**
- Calendar life > **10 years**
- Excellent **temperature** robustness (-20 °C up to +60 °C)
- **Flexible** deployment : up to 16 packs in parallel
- **Constant power** during discharge (very low internal resistance)
- **Very low Peukert's losses** (energy efficiency >98 %)
- **Very low self discharge** (<3 % per month)
- **Deep discharge** allowed up to 100 %
- **No memory effect**
- About **50 % lighter** and **40% smaller** than equivalent Lead-AGM battery with same usable energy
- **Certification : CE, RoHS, UN 38.3, Cell : IEC 62619**

## Technical Specifications

Electric	Nominal voltage / Nominal capacity	12.8V / 212Ah
	Stored energy	2714 Wh
	Volumetric energy density / Specific energy	121.2 Wh/L / 142.8 Wh/Kg
	Internal resistance	≤ 10mΩ
	Cycles	> 4500 cycles (see chart)
	Self discharge	< 3% per month
	Energy efficiency	> 98%
Standard Charge	Charge voltage	14.4 V ± 0.2 V (Optional floating voltage : 13.36V max)
	Charge mode	CC/CV : Constant Current / Constant Voltage
	Continuous charge current / Maximum charge current	180A / 200A
	BMS charge cut-off voltage	14.8V ± 0.1V
Standard Discharge	Instant peak discharge current	800A (300 ms)
	Continuous discharge current	180A
	Maximum discharge current (< 30s)	220A
	BMS discharge cut-off voltage	10V
Environment	Charge temperature range	0°C to +55°C
	Discharge temperature range	-20°C to 60°C
	Storage conditions	0°C to +50°C @60±25% relative humidity
	IP protection level	IP65
Mechanical	Type of cells	Solid-State LiFePO <sub>4</sub> cells
	Casing material	ABS
	Dimensions	505x185x242 mm
	Weight	19.0 kg
	Terminal	M8

 **Solid-State Technology**

 **Active Balancing**

 **BlueTooth**

## APPLICATIONS :

-  **Electrical vehicles and utilities**
-  **Industrial carts and forklifts**
-  **Marine applications**
-  **Street lightning**
-  **CCTV and security camera**
-  **Robotics and AGVs**
-  **Solar and wind energy storage**

and much more...

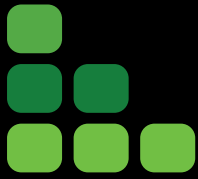

# PowerBrick Solid State

Lithium-Ion battery

Smart

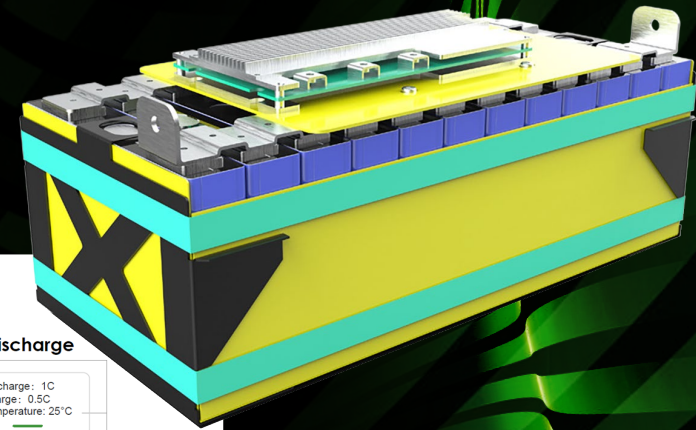

## Charts and curves

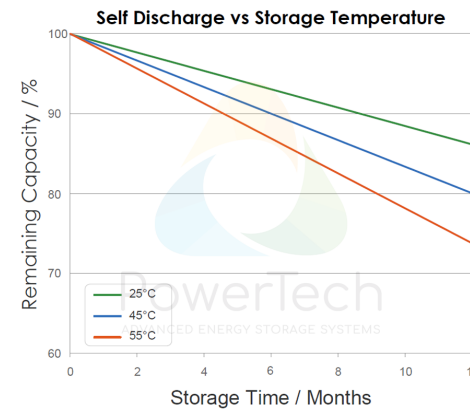
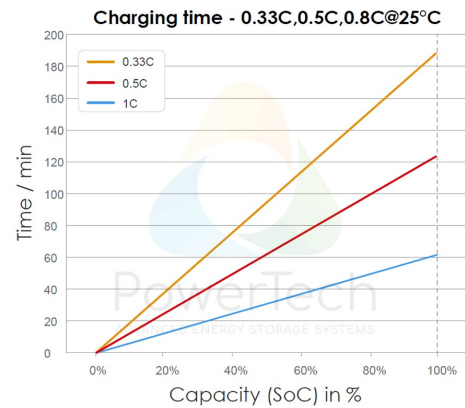
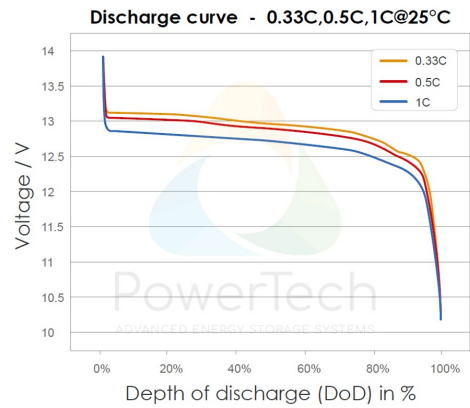
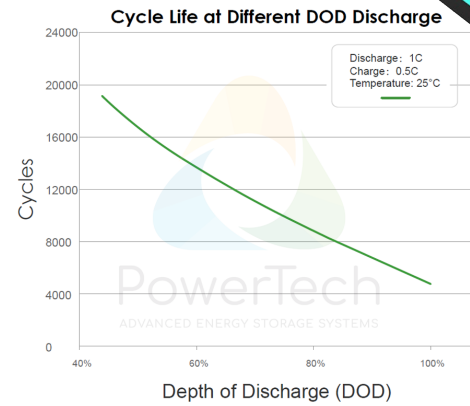
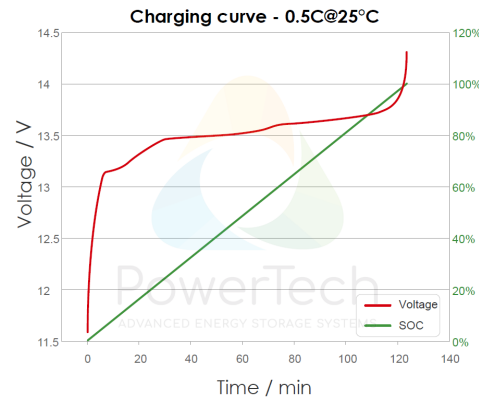
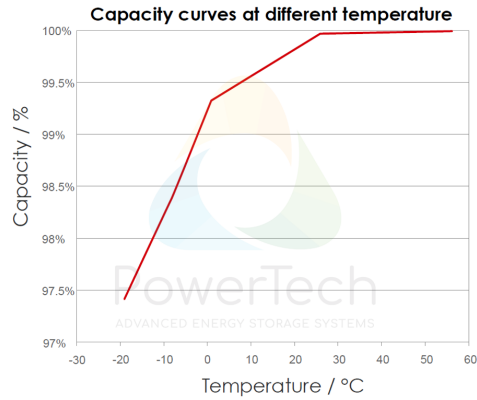

## Dimensions

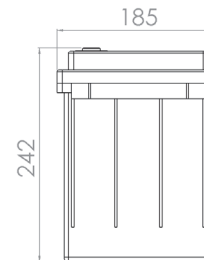
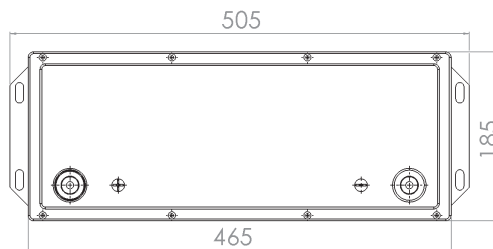
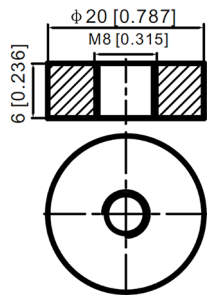

Solid-State Technology

Active Balancing

BlueTooth



**PowerTech**  
systems

V1.5

PowerTech Systems SAS  
ZA Charles Renard - Batiment A1  
6 Bld Georges Guynemer  
78210 ST CYR L'ECOLE - France

SAS au capital de 1 000 000 Euros  
SIREN : 793926577 - TVA : FR33793926577

[www.powertechsystems.eu](http://www.powertechsystems.eu)  
+33 185 400 970  
[contact@powertechsystems.eu](mailto:contact@powertechsystems.eu)